

New

OMFB[®]

HYDRAULIC COMPONENTS

New PTO's "LIGHT" series

OMFB is pleased to introduce the **new side mounting PTO's series LIGHT for ISUZU and IVECO** transmissions on LCV trucks.

Thanks to a new die-cast aluminium housing, we have developed extremely lightweight PTO with a weight reduction of 40% compared to similar unit with cast iron housing, yet ensuring strength and reliability.

Available with either mechanical or "MAGTRONIC" electromagnetic engagement systems, their compact-size dimensions and lightness make the installation of these PTO's easy and quick.

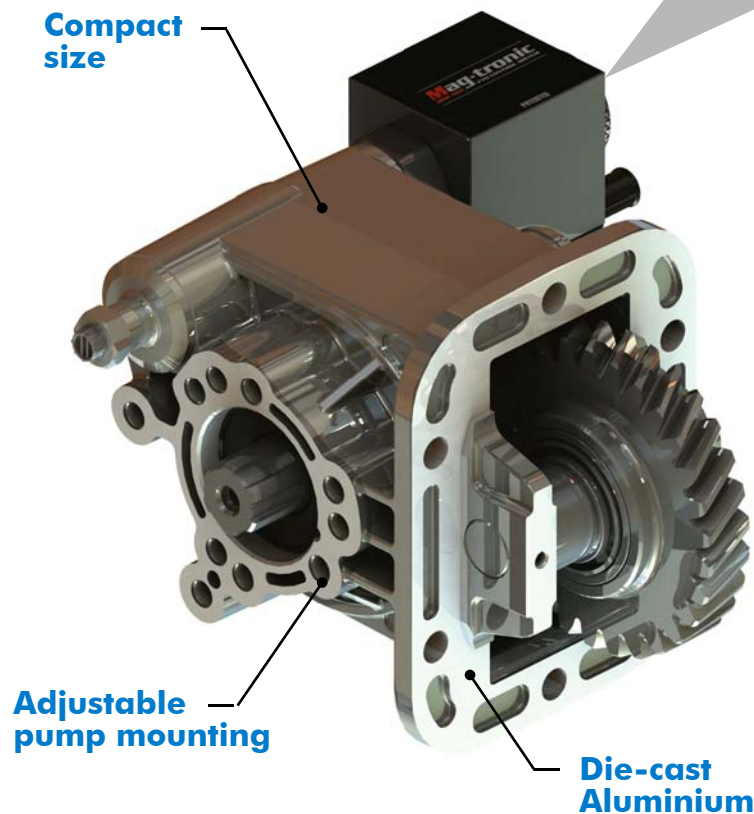

ENGAGEMENT SYSTEMS

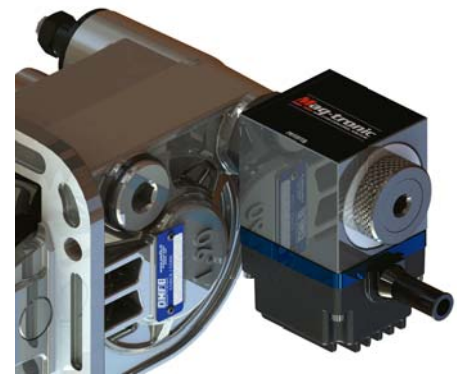

APPLICATIONS

- Light-duty tippers
- Crane/light duty tipper
- Overhead platforms on LCV trucks

PTO LIGHT series with mechanical engagement – pump versions 09 & 13 – for gearbox IVECO 2835.6

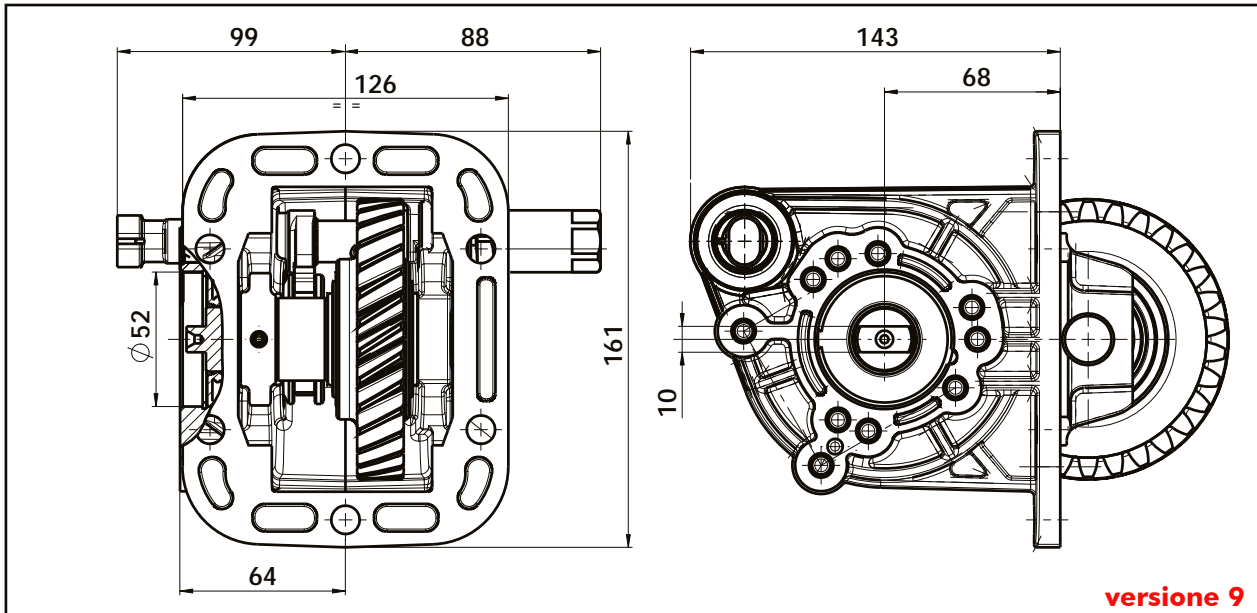

versione 9

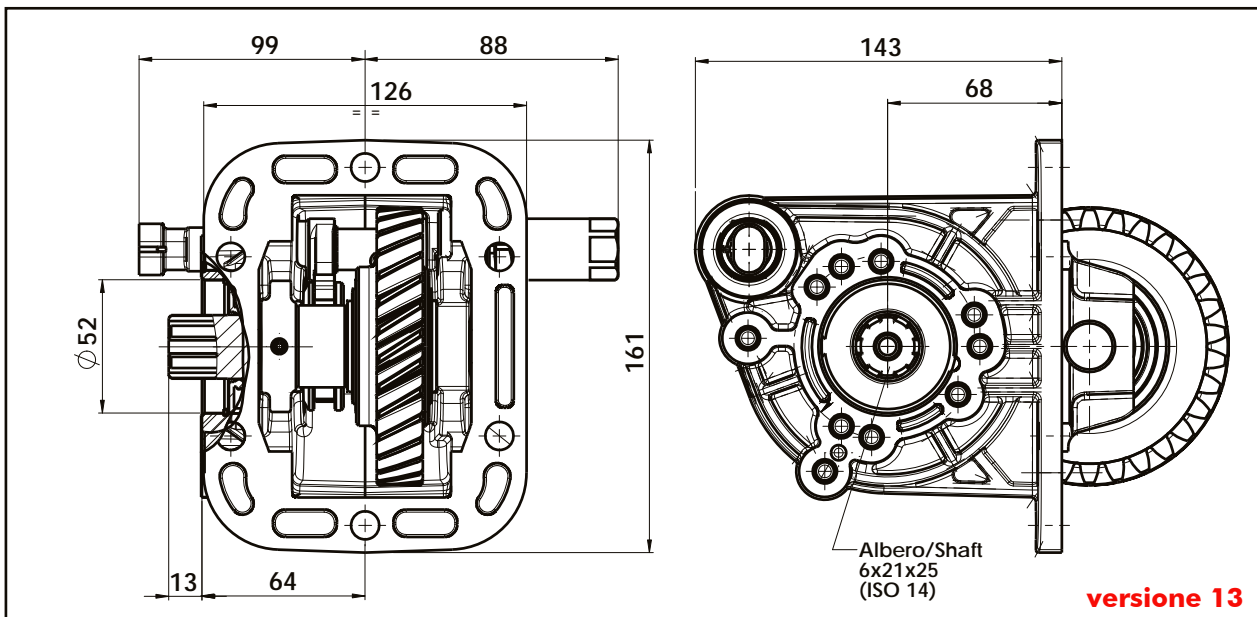

versione 13

Gearbox	PTO code	Version	Pto ratio@1000 eng.rpm rpm	Max torque Nm	Mounting side	Output	Rotation	Mounting kit	Weight Kg
2835.6	001-090-00090	09	1200	100	Sx Left	Poster. Rear	Orar. Cw	154-002-03394	5
	001-090-00134	13							

PTO LIGHT series with electromagnetic engagement – pump versions 09 & 13 – for gearbox IVECO 2835.6

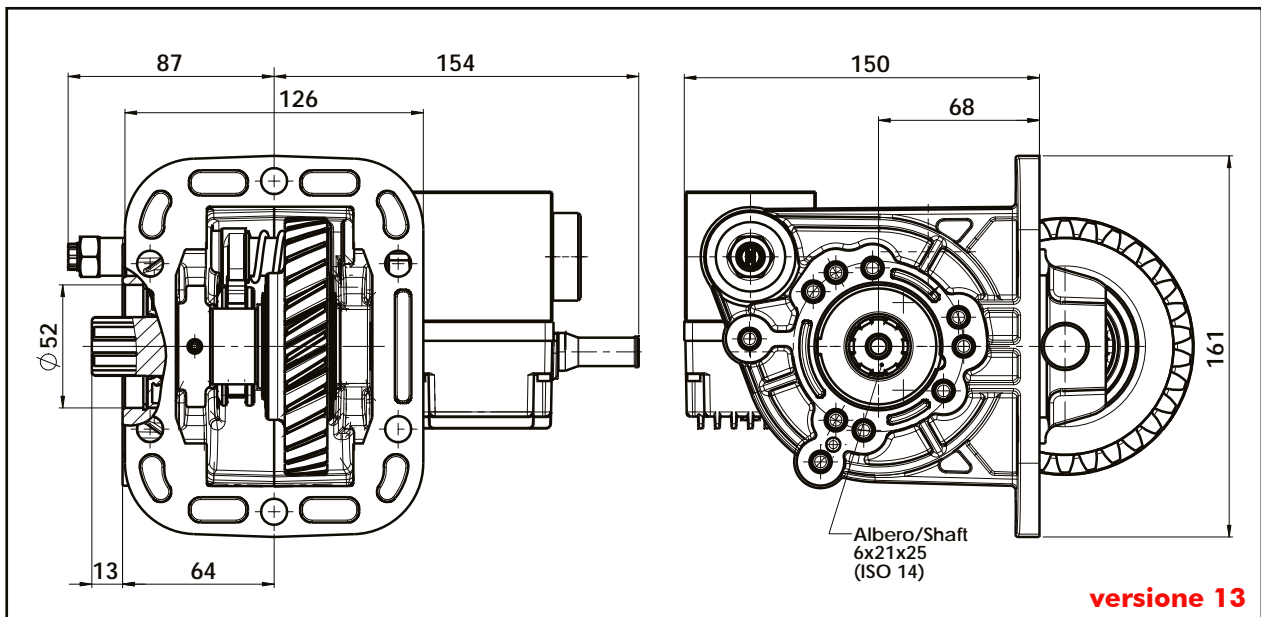
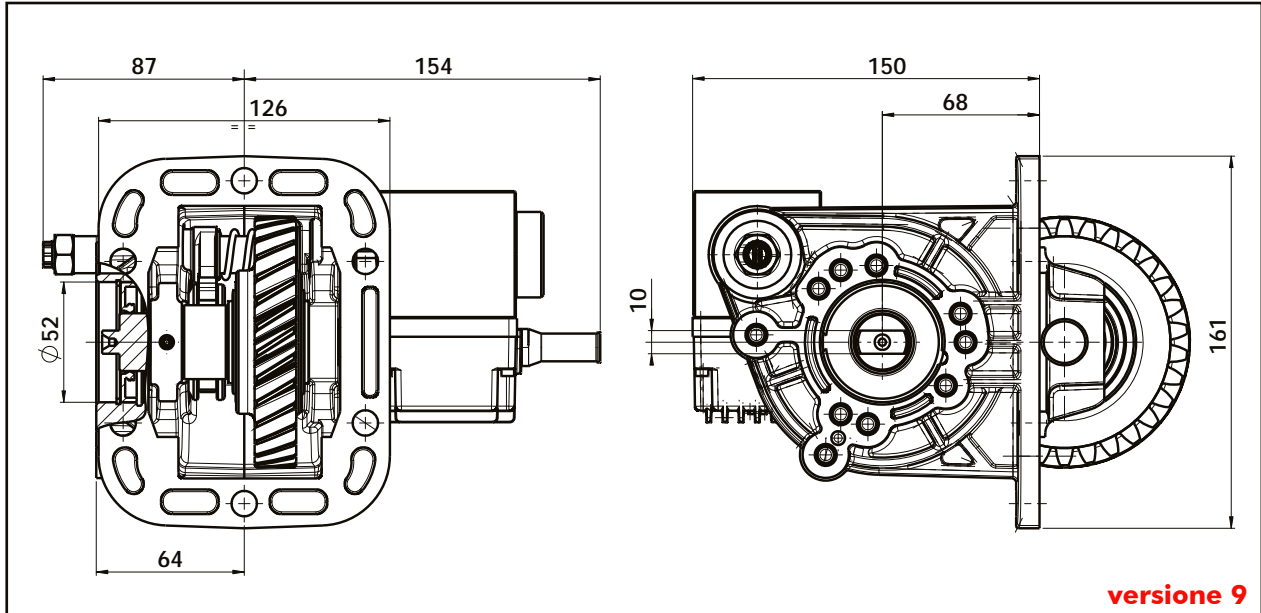

Gearbox	PTO code	Version	Pto ratio@1000 eng.rpm rpm	Max torque Nm	Mounting side	Output	Rotation	Mounting kit	Weight Kg
2835.6	001-590-00095	09	1200	100	Sx Left	Poster. Rear	Orar. Cw	154-002-03394	6,9
	001-590-00139	13							

PTO LIGHT series with mechanical engagement – pump versions 09 & 13 – for gearbox ISUZU MYY 6E

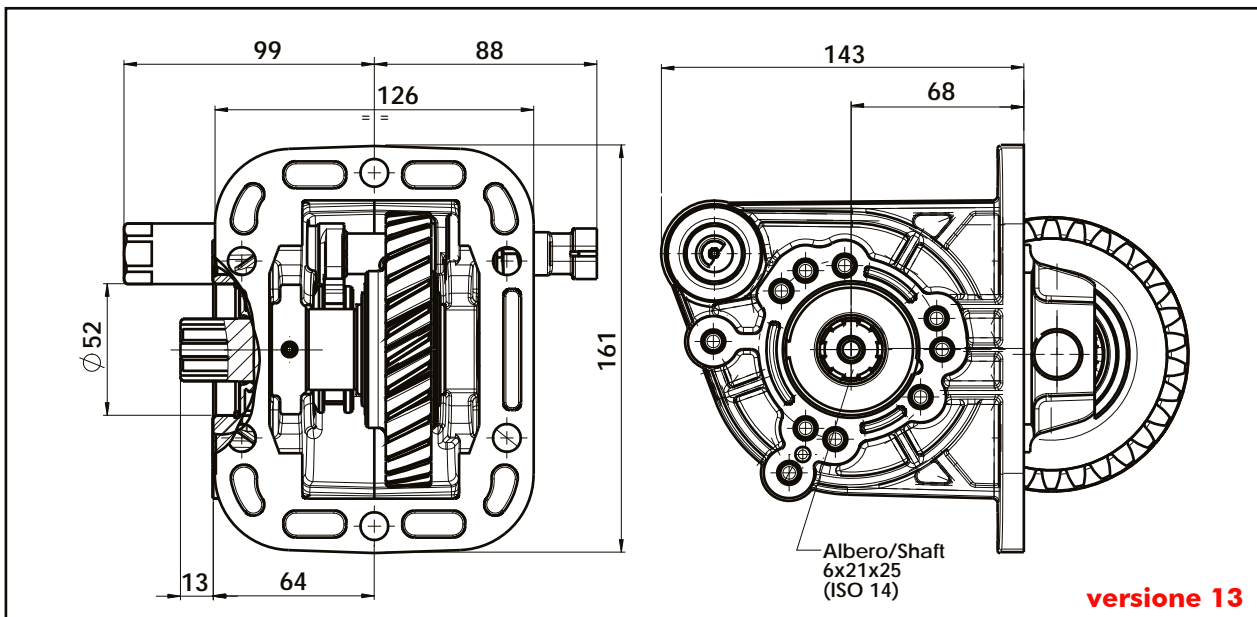
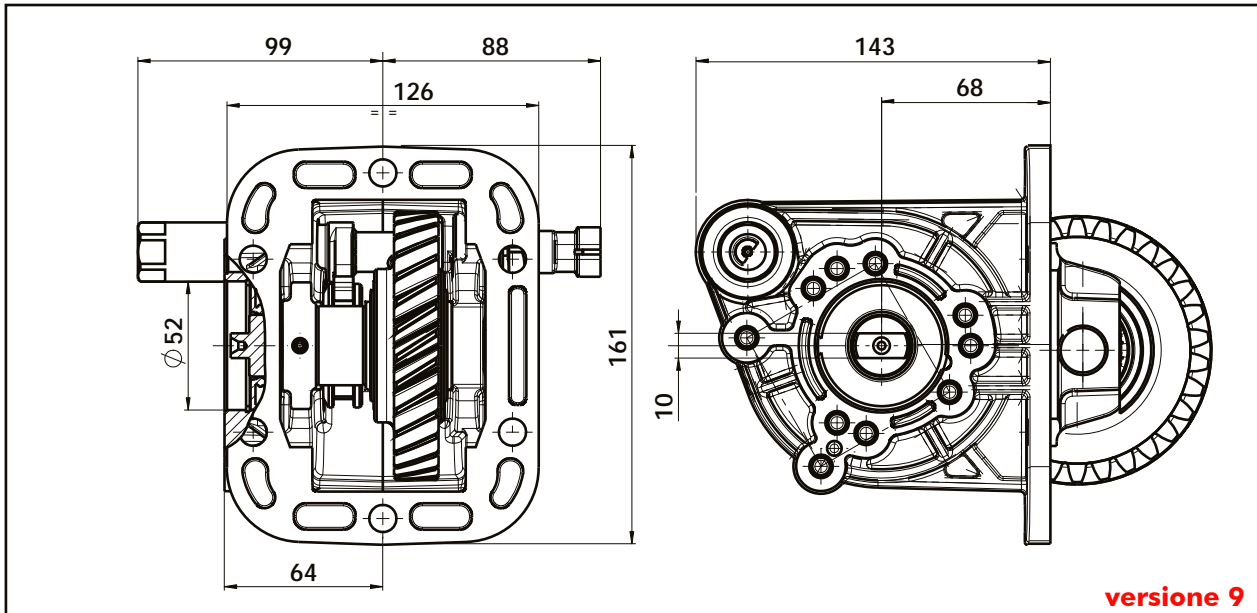

Gearbox	PTO code	Version	Pto ratio@1000 eng.rpm rpm	Max torque Nm	Mounting side	Output	Rotation	Mounting kit	Weight Kg
MYE 6E	071-095-00098	09	745	100	Sx Left	Poster. Rear	Orar. Cw	154-002-03240	5
	071-095-00132	13							

PTO LIGHT series with electromagnetic engagement – pump versions 09 & 13 – for gearbox ISUZU MYY 6E

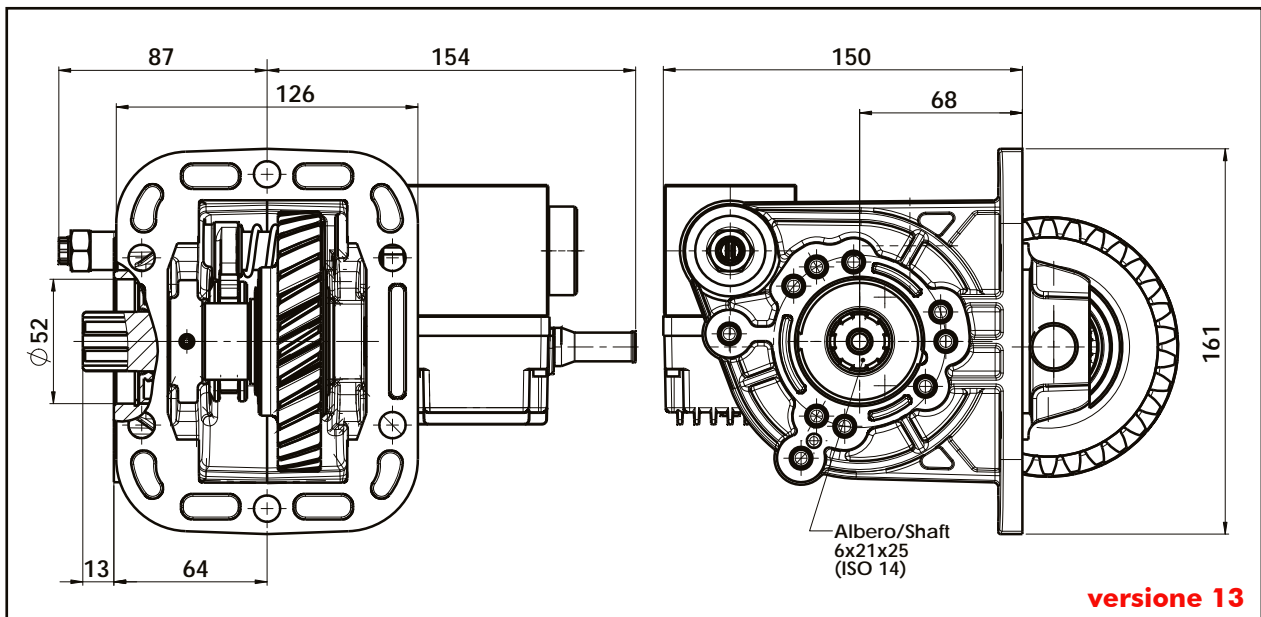
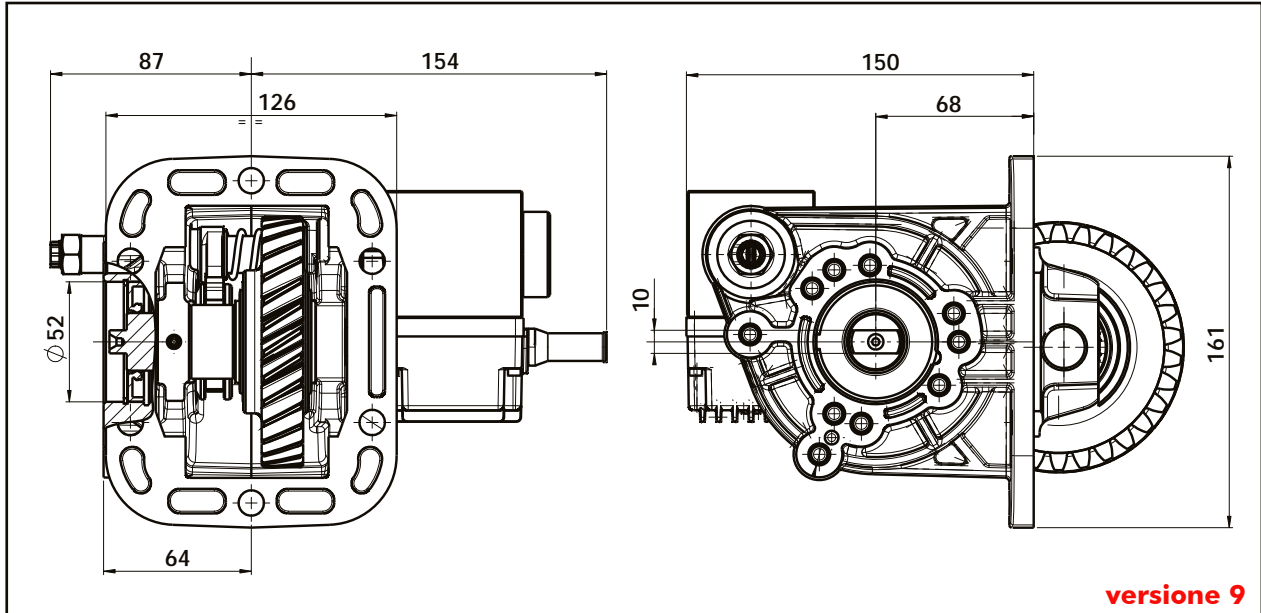

Gearbox	PTO code	Version	Pto ratio@1000 eng.rpm rpm	Max torque Nm	Mounting side	Output	Rotation	Mounting kit	Weight Kg
MYE 6E	071-595-00093	09	745	100	Sx Left	Poster. Rear	Orar. Cw	154-002-03240	6,9
	071-595-00137	13							

PTO LIGHT series with mechanical engagement – pump versions 09 & 13 – for gearbox ISUZU MYY 5T/5D/5R/6P/6S

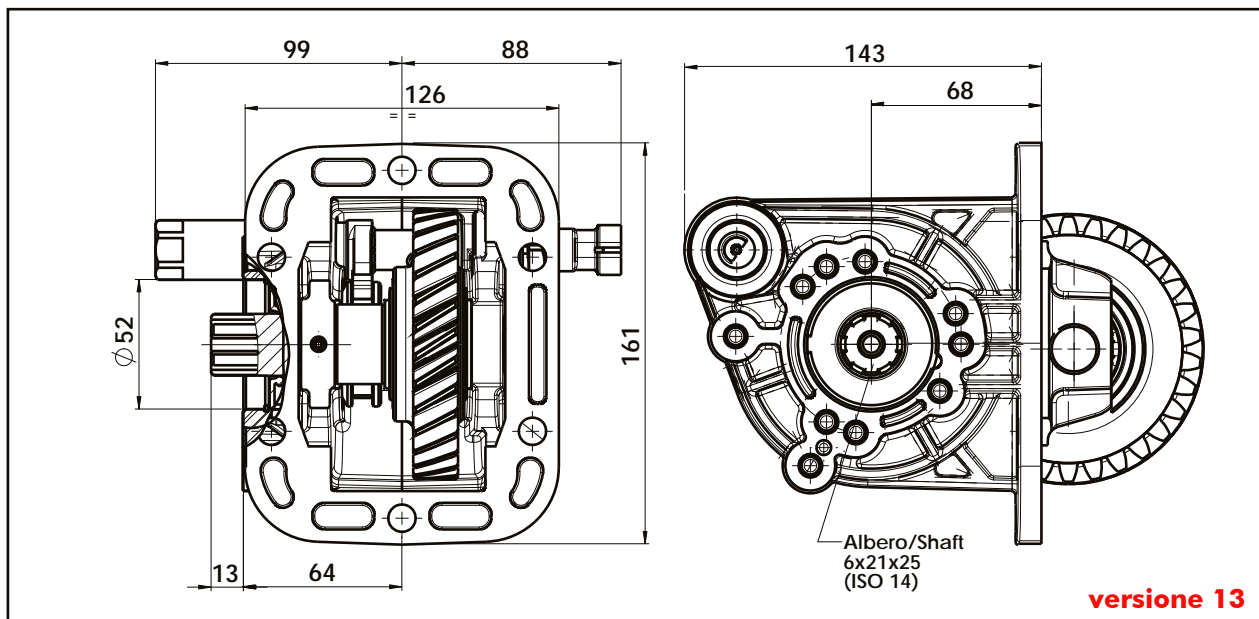
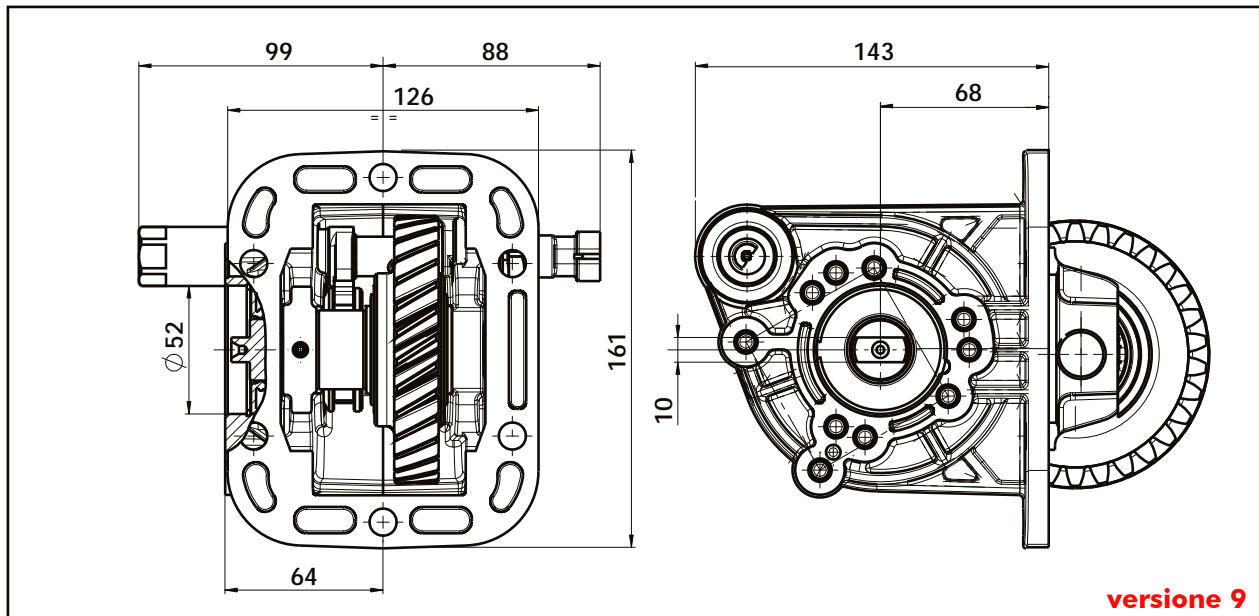

Gearbox	PTO code	Version	Pto ratio@1000 eng.rpm rpm	Max torque Nm	Mounting side	Output	Rotation	Mounting kit	Weight Kg
MY5T/ 5D/5R 6P-6S	071-093-00090	09	930	100	Sx Left	Poster. Rear	Orar. Cw	154-002-03240	5
			827						
MY5T/ 5D/5R 6P-6S	071-093-00134	13	930	100	Sx Left	Poster. Rear	Orar. Cw	154-002-03240	5
			827						

PTO LIGHT series with electromagnetic engagement - pump versions 09 & 13 - for gearbox ISUZU MYY 5T/5D/5R/6P/6S

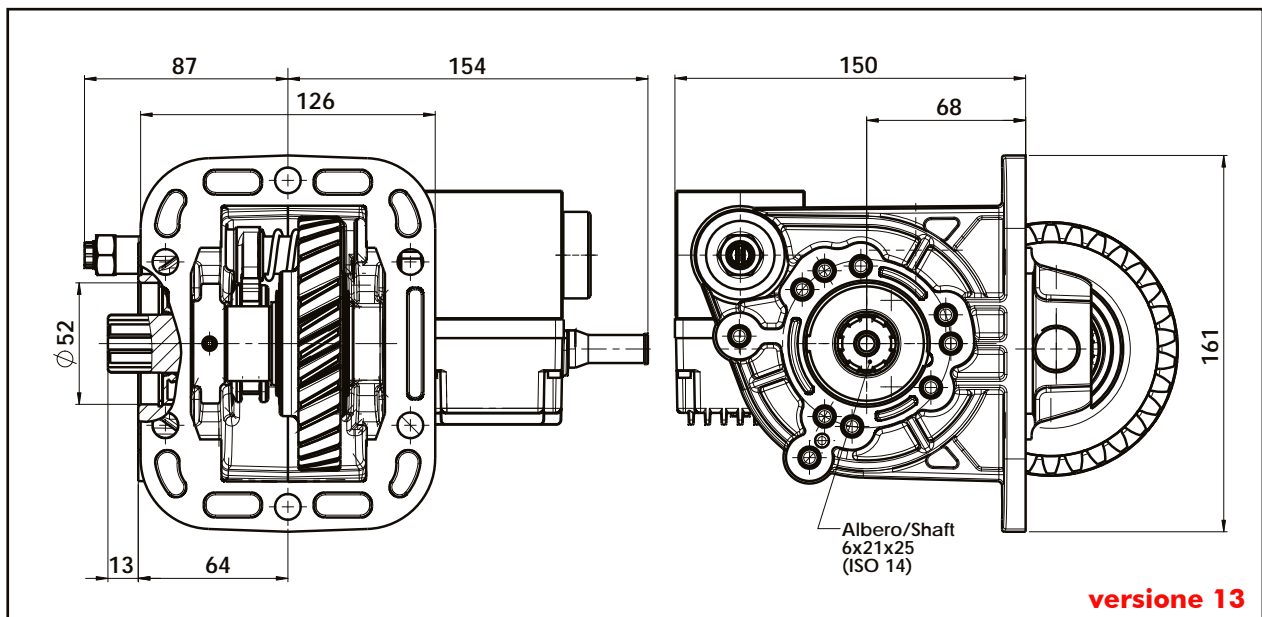
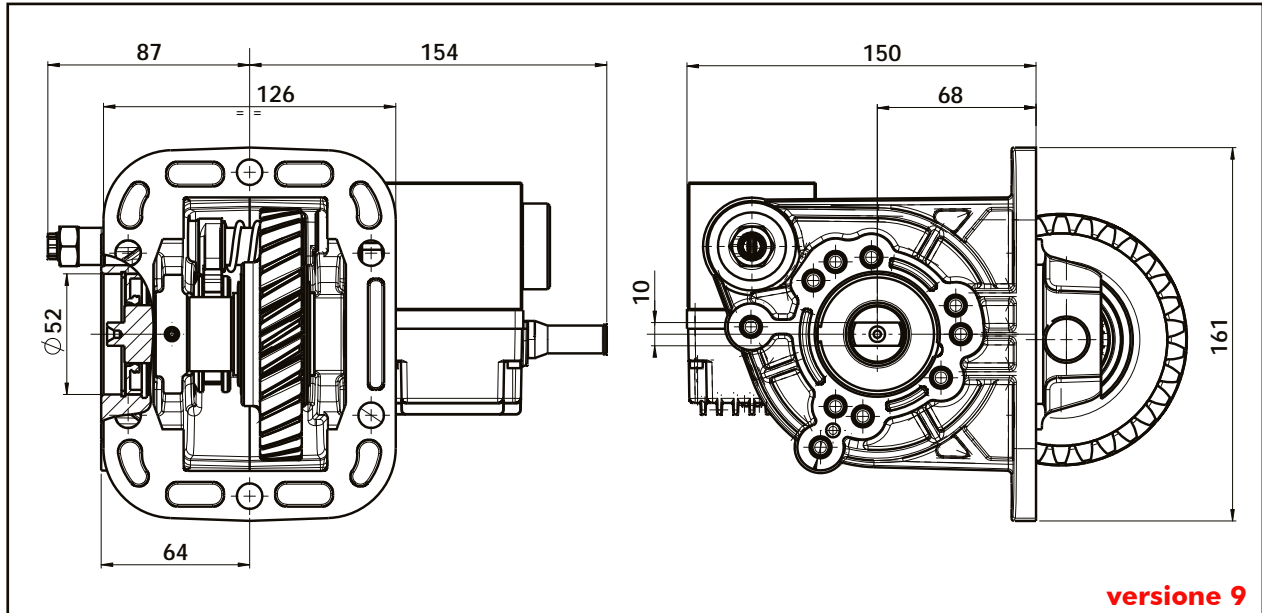

Gearbox	PTO code	Version	Pto ratio@1000 eng.rpm rpm	Max torque Nm	Mounting side	Output	Rotation	Mounting kit	Weight Kg
MYY 5T/5D/5R	071-593-00095	09	930	100	Sx Left	Poster. Rear	Orar. Cw	154-002-03240	6,9
6P-6S			827						
MYY 5T/5D/5R	071-593-00139	13	930	100	Sx Left	Poster. Rear	Orar. Cw	154-002-03240	6,9
6P-6S			827						

PTO LIGHT series with mechanical engagement – pump versions 09 & 13 – for gearbox ISUZU MYY 5A

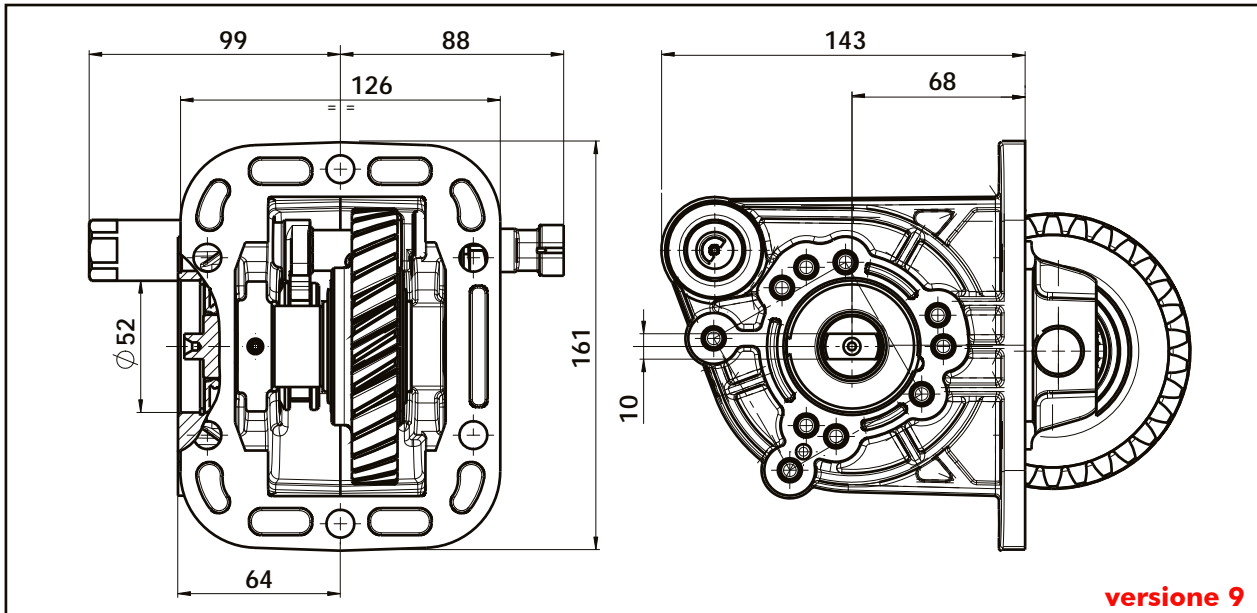

versione 9

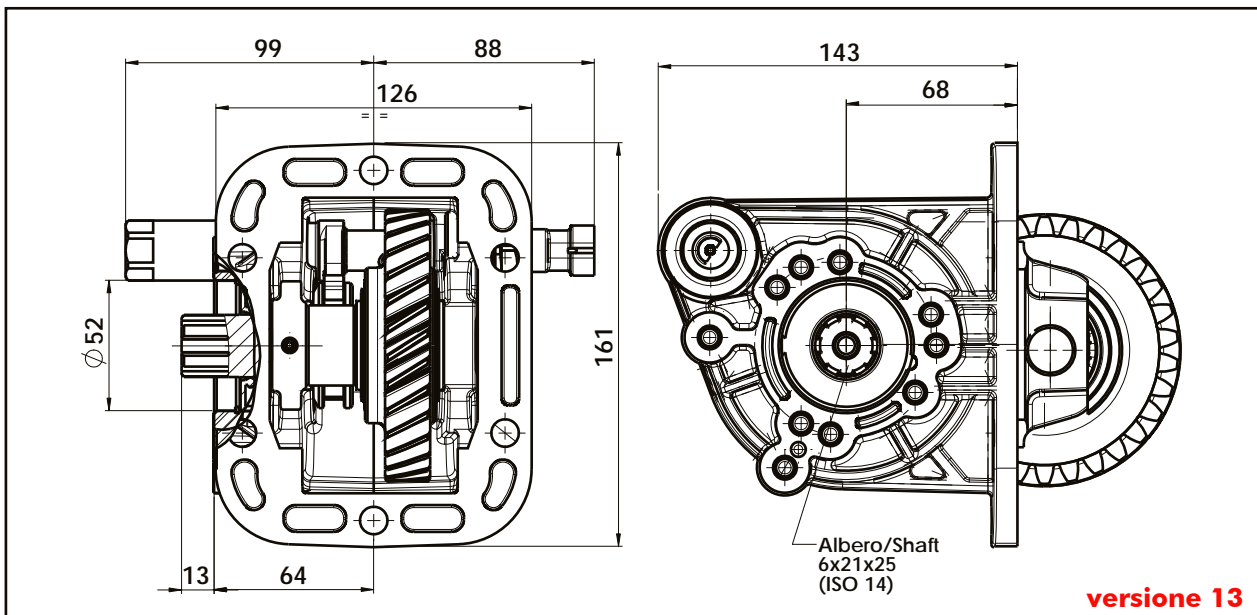

versione 13

Gearbox	PTO code	Version	Pto ratio@1000 eng.rpm rpm	Max torque Nm	Mounting side	Output	Rotation	Mounting kit	Weight Kg
MYE 5A	071-094-00099	09	930	100	Sx Left	Poster. Rear	Orar. Cw	154-002-03240	5
	071-094-00133	13							

PTO LIGHT series with electromagnetic engagement – pump versions 09 & 13 – for gearbox ISUZU MYY 5A

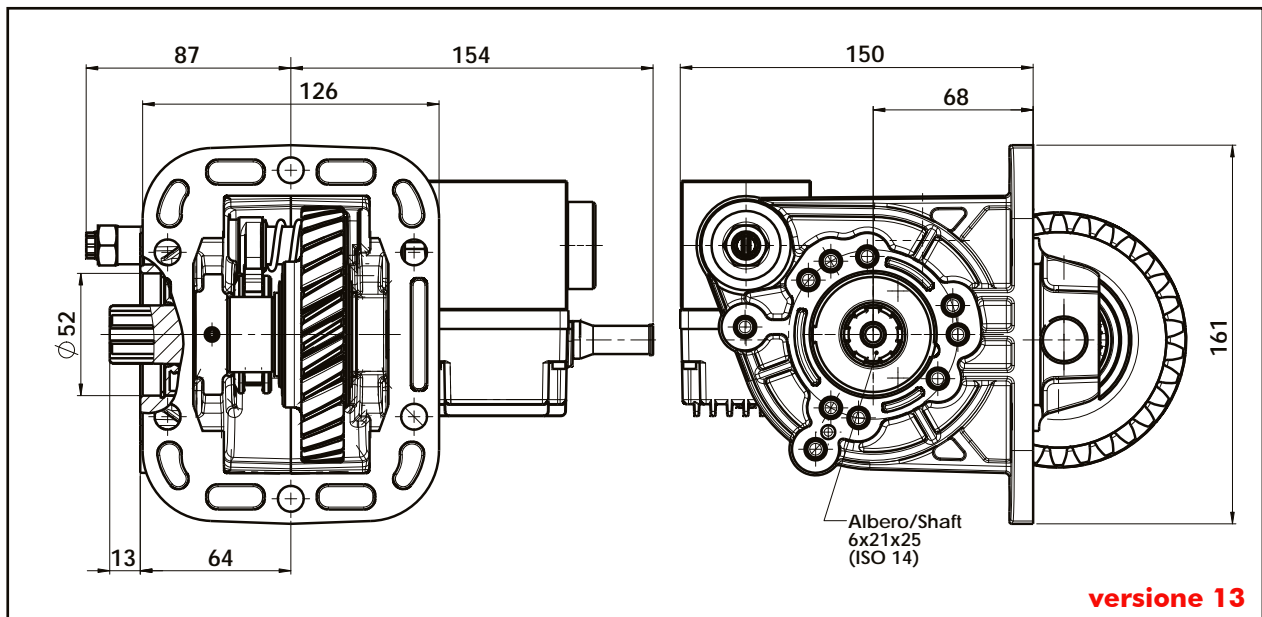
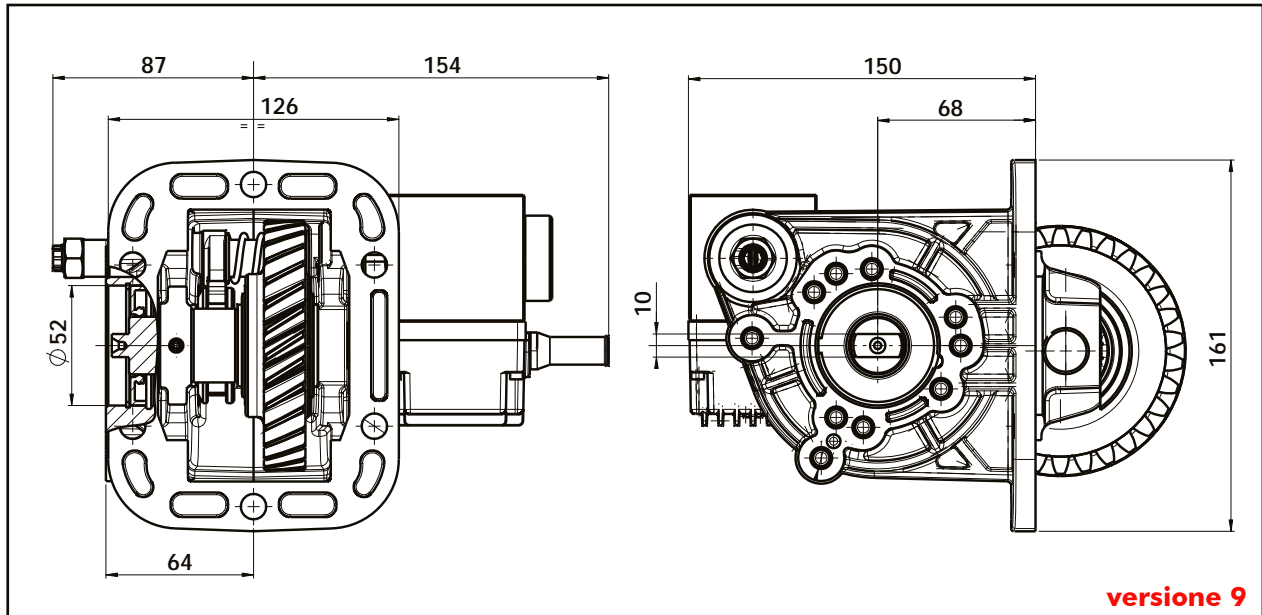

Gearbox	PTO code	Version	Pto ratio@1000 eng.rpm rpm	Max torque Nm	Mounting side	Output	Rotation	Mounting kit	Weight Kg
MYY 5A	071-594-00094	09	930	100	Sx Left	Poster. Rear	Orar. Cw	154-002-03240	6,9
	071-594-00138	13							

PTO/PUMP COUPLING version 09

All the PTO's series LIGHT version 09 can only mount industrial pumps type 2P- 52mm diameter with milled shank shaft.

Application: LIGHT DUTY TIPPERS

Pump 2P type

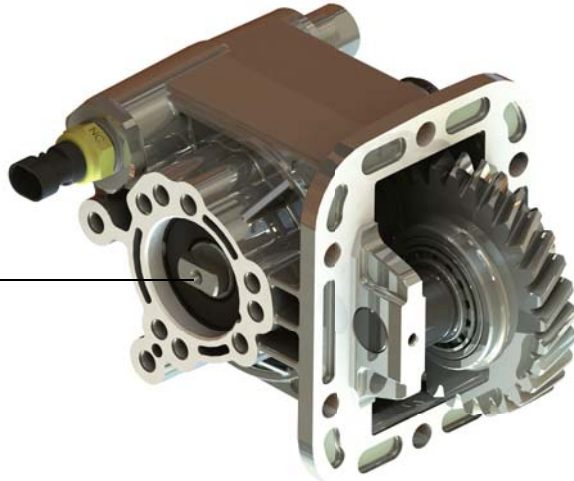

TECHNICAL FEATURES - 2P GEAR PUMPS									
Pump type	Code	Rotation	Displacement cm ³ /rev	Max. pressure bar			Speed rpm		Weight Kg
				P1	P2	P3	MAX.	MIN.	
2P 4	149-200-00441	Left	4	270	285	300	4000	600	3
2P 6	149-200-00469		6						3,1
2P 10	149-200-00487		10				3,3		
2P 12	149-200-00503		12	3000	500	4000	500	3,4	
2P 16	149-200-00530		16					250	265
2P 20	149-200-00558		20	220	235	250	3200	400	4
2P 22	149-200-00576		22						3000
2P 25	149-200-00594		25	200	215	230	3000	400	4,5

PTO/PUMP COUPLING version 13

All the PTO's series LIGHT version 13 can mount standard pumps series KIPP and/or NPLU.

Application: LIGHT DUTY TIPPERS; CRANE/LIGHT DUTY TIPPERS; OVERHEAD PLATFORMS ON LCV TRUCKS.

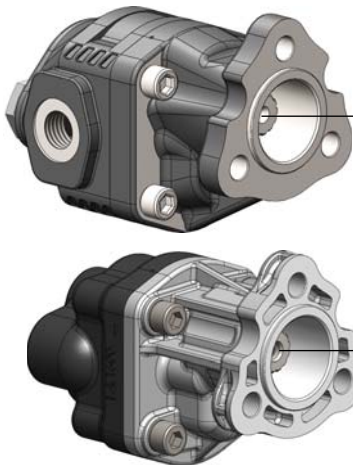

NPLU pumps
(Crane/light tippers - Overhead platform on LCV trucks)

KIPP pump
(Light duty tipper)

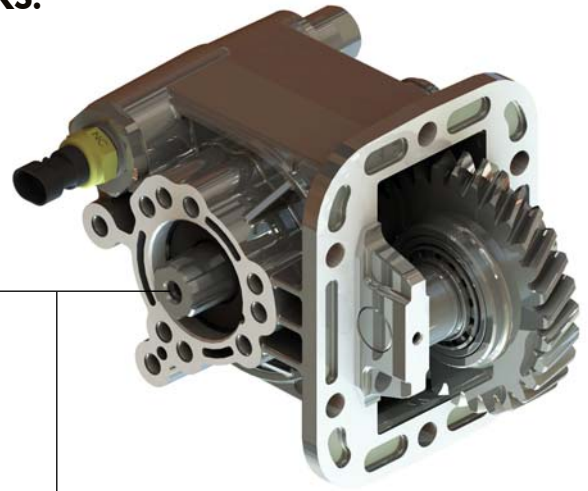



TECHNICAL FEATURES - NPLU GEAR PUMPS												
Pump type	Code	Rotation	Displacement	Pressure bar			Max. continuous speed	Max. intermittent speed	Min. speed	IN	OUT	Weight
			cm ³ /rev	P1	P2	P3	rpm	rpm	rpm			Kg
NPLU 10	105-003-20108	Left	10,06	280	310	325	2200	3000	300	G 3/4"	G 1/2"	5.2
NPLU 12	105-003-20126		11,92									5.3
NPLU 14	105-003-20144		13,8									5.4
NPLU 16	105-003-20162		16,03									5.6
NPLU 20	105-003-20206		20,12	260	280	290	5.9					
NPLU 25	105-003-20251		25,15	220	250	260	6.5					
NPLU 32	105-003-20322		32,04	190	210	220	7					
NPLU 40	105-003-20402		39,93	160	180	190	1800	2500				7.5

TECHNICAL FEATURES - KIPP GEAR PUMPS												
Pump type	Code	Rotation	Displacement	Pressure bar			Max. continuous speed	Max. intermittent speed	Min. speed	IN	OUT	Weight
			cm ³ /rev	P1	P2	P3	rpm	rpm	rpm			Kg
KIPP 16	105-003-50166	Left	16,03	140	150	160	2200	3000	300	G 3/4"	G 1/2"	3.2
KIPP 20	105-003-50200		20,12									3.5

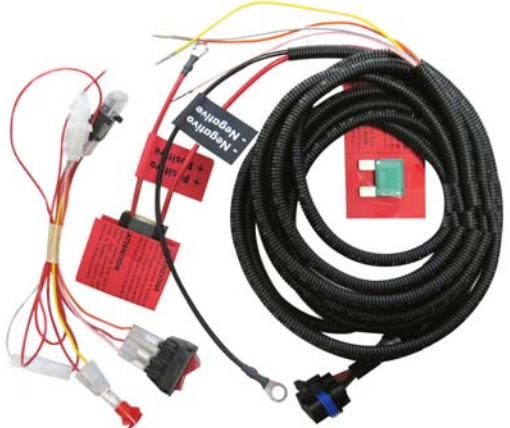
P1=Max. continuous pressure (100%)
P2=Max. Intermittent pressure (20 sec.max.)
P3=Max. peak pressure (6 sec.max.)

Electromagnetic PTO control - MAGTRONIC		
12V	ONLY PTO Control code 301-000-03124	
	PTO + Electric tipping valve control - code 301-000-03160	
24V	ONLY PTO Control code 301-000-03142	
	PTO + Electric tipping valve control - code 301-000-03188	

Cable PTO control - LINEA BAYONET			
MODEL	ORDER CODE	CABLE LENGHT	
LINEA 150	101-018-01504	1500 mm	
LINEA 200	101-018-02003	2000 mm	
LINEA 250	101-018-02503	2500 mm	
LINEA 300	101-018-03002	3000 mm	
LINEA 350	101-018-03502	3500 mm	
TECHNICAL FEATURES		PHISICAL FEATURES	
<ul style="list-style-type: none"> - Stroke 40 mm - Transmitted force: Traction 600 N/Thrust 350 N - Sheat bending radius: 250 mm minimum 		<ul style="list-style-type: none"> - Body in glass-filled nylon. - Pressed steel lever with tropicalised galvanic protection. - Rack in high strength synthetic compound. - Reinforced sheath with self-lubrificated antifriction core. 	

Cable PTO control - PUSH-PULL BAYONET			
MODEL	ORDER CODE	CABLE LENGHT	
PUSH-PULL 120	101-019-01209	1200 mm	
PUSH-PULL 150	101-019-01503	1500 mm	
PUSH-PULL 200	101-019-02002	2000 mm	
PUSH-PULL 250	101-019-02502	2500 mm	
PUSH-PULL 300	101-019-03001	3000 mm	
PUSH-PULL 350	101-019-03501	3500 mm	
TECHNICAL FEATURES		PHISICAL FEATURES	
<ul style="list-style-type: none"> - Stroke 40 mm - Transmitted force: Traction 400 N/Thrust 350 N - Sheat bending radius: 250 mm minimum 		<ul style="list-style-type: none"> - Body in steel - Knob in high strength synthetic material - Cable in high strength steel - Reinforced sheath with self-lubrificated antifriction core 	